



MT2510 THRU MT2516

Three Phase 25.0 AMP Glass Passivated Bridge Rectifier

1. Features

- Glass passivated die construction.
- Low forward voltage drop.
- High surge current capability
- Ideal for printed circuit board.

Case: MT

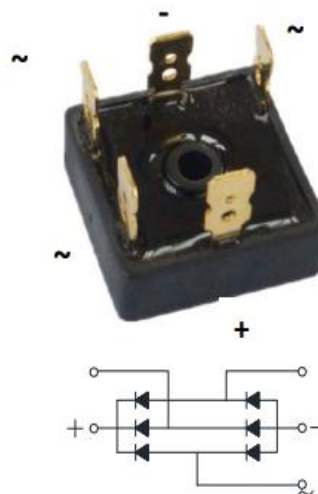

Dimensions in millimeters

2. Mechanical Data

- Case: MT Molded Plastic .
- Epoxy: UL 94V-0 rate flame retardant.
- Terminals: Plated Leads Solderable per MIL-STD-202, Method 208.
- Polarity: marked on body
- Marking Information: Type Number
- Mounting Position : Any.

3. Maximum Ratings and Electrical Characteristics

Rating at 25°C ambient temperature unless otherwise specified

For capacitive load derate current by 20%.

Type Number	SYMBOL	MT2510	MT2512	MT2514	MT2516	UNIT
Maximum Recurrent Peak Reverse Voltage	V _{RRM}	1000	1200	1400	1600	V
Average Rectified Output Current@60Hz sine wave, R-load, T _C =55℃ (with heatsink)	I _{F(AV)}	25				A
Peak Forward Surge Current 8.3ms Single half sine-wave superimposed on rated load (JEDEC Method)	I _{FSM}	400				A
Rating for fusing (t<8.3ms)	I ² t	664				A ² s
Forward Voltage @I _F =12.5A	V _{FM}	1.20				V
Peak Reverse Current@T _A =25℃	I _R	5				uA
At Rated DC Blocking Voltage@T _J =125℃		1000				
Dielectric Strength	V _{ids}	2500				V
The proposed installation torque	T _{or}	10				Kgf.cm
Typical Thermal Resistance Junction to Case(with heatsink)	R _{θJC}	1.7				℃/W
Operating Temperature Range	T _J	-55 to +150				℃
Storage Temperature Range	T _{STG}	-55 to +150				℃



MT2510 THRU MT2516

Three Phase 25.0 AMP Glass Passivated Bridge Rectifier

4. Rating And Characteristic Curves

Fig.1 Output Current Derating Curve

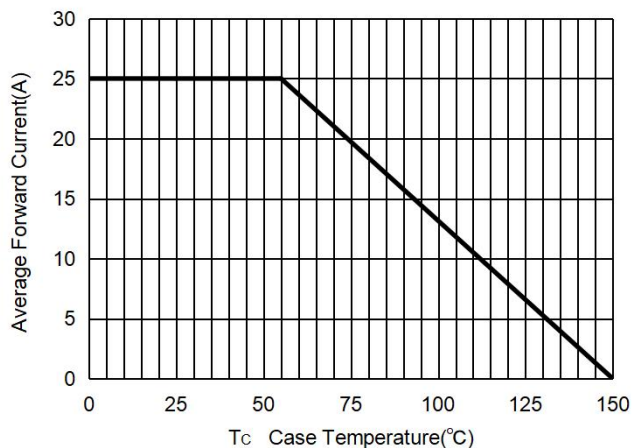

Fig.2 Typical Forward Characteristics

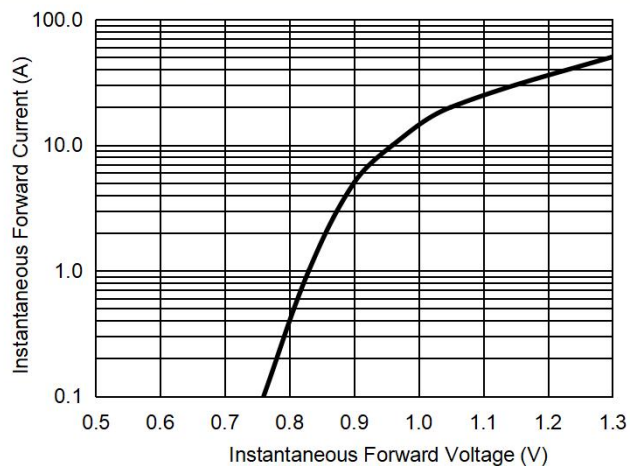

Fig.3 Maximum Peak Forward Surge Current

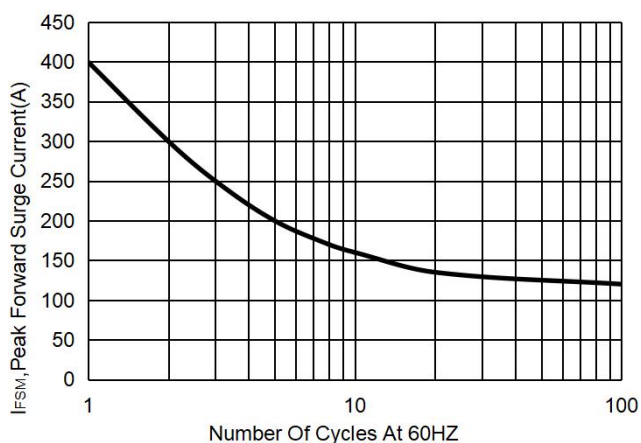
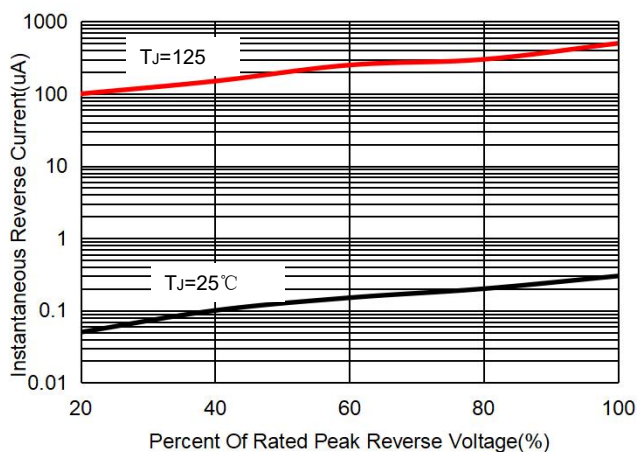
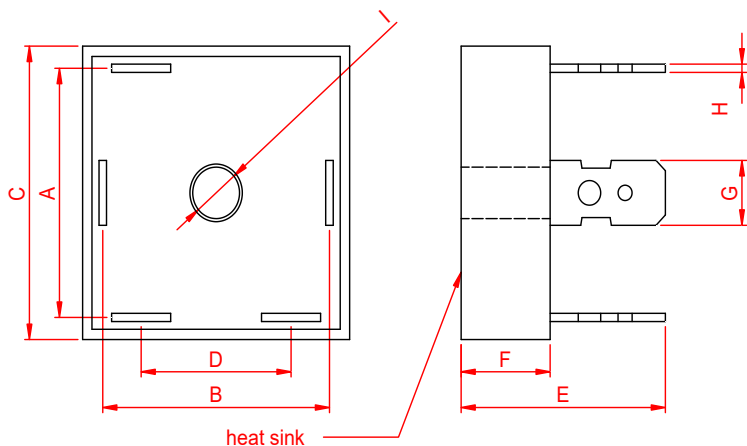

Fig.4 Typical Reverse Characteristics



5. Dimensions



Dimensions	Inches		Millimeters	
	Min	Max	Min	Max
A	0.909	0.949	23.10	24.10
B	0.909	0.949	23.10	24.10
C	1.102	1.142	28.00	29.00
D	0.610	0.650	15.50	16.50
E	0.819	0.984	20.80	25.00
F	0.354	0.394	9.00	10.00
G	0.240	0.256	6.10	6.50
H	0.024	0.039	0.60	1.00
I	0.177	0.220	4.50	5.60



Important Notice and Disclaimer

- Reproducing and modifying information of the document is prohibited without from XINNUO.
- XINNUO reserves the right to make changes to this document and its products and specifications.
- XINNUO disclaims any and all liability arising out of the application or use of any product including damages incidentally and consequentially occurred.
- XINNUO does not assume any and all implied warranties, including warranties of fitness for particular purpose, non-infringement and merchantability.
- Applications shown on the here in document are examples of standard use and operation. Customers are responsible in comprehending the suitable use in particular applications. XINNUO makes no representation or warranty that such applications will be suitable for the specified use without further testing or modification.
- The products shown her are not designed and authorized for equipments requiring high level of reliability or relating to human life and for any applications concerning life-saving or life-sustaining, such as medical instruments, transportation equipment, aerospace machinery et cetera. Customers using or selling these products for use in such applications do so at their own risk and agree to fully indemnify XINNUO for any damages resulting from such improper use or sale.
- Since XINNUO uses lot number as the tracking base, please provide the lot number for tracking when complaining.